

Exploded View

PIAWMZ368800B
22022316001305
208And230V_1Ph

Export Time:

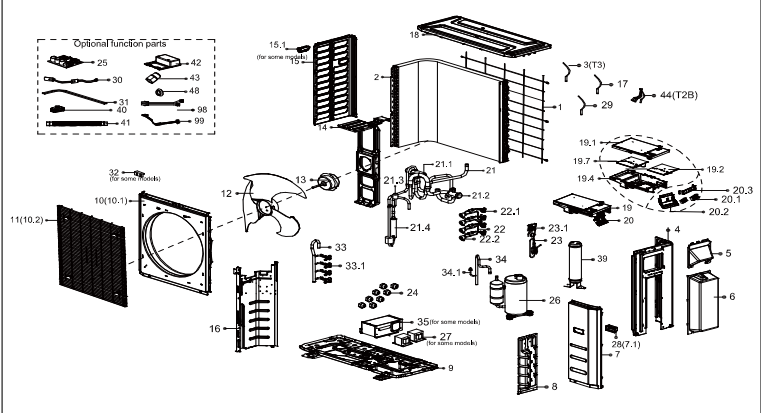

No.	Part Name	Quantity	BOM Code	Remark1	Remark2
1	Rear Grille	1.0	12222000006604		
2	Condenser assembly	1.0	15822000009578		
3	Pipe temperature sensor subas	1.0	11201007003442	CGQ-WD/GW4100-1.85	
4	rear right side plate assembl	1.0	12222000012226		
5	handle	1.0	12222000011085		
6	Water collector	1.0	12122300000110		
7	front right side plate assem	1.0	12222500A00135		
7.1	Handle	1.0	12100702000038		
8	Valve plate	1.0	12222000005282		
9	Chassis assembly	1.0	12222000005267		
10	Front panel	1.0	12222000A01431		
11	Air outlet grille	1.0	12222000014845		
12	axial flow fan	1.0	12100105000084	ZL-560*139*12-3KN	
13	Brushless DC motor	1.0	11002015000247	ZKFN-120-8-2	
14	Motor bracket assembly	1.0	12222500000547		
15	Left supporter	1.0	12222000006665		
15.1	Small handle	1.0	12100701000033		
16	Partition board subassembly	1.0	12222200007795		
17	Ambient temperature sensor	1.0	11201007003448		
18	Top cover assembly	1.0	12222500000587		
19	Electronic control box subass	1.0	17222300002648	US1-KFR105W/BP3T4	
19.1	Cover of electronic control b	1.0	12122000006905		
19.2	Outdoor main control board su	1.0	17122300003973	US1-KFR105W/BP3T4	
19.4	Electronic installing box	1.0	12122300000170		
19.7	Inverter module subassembly	1.0	171220000052007	US1-KFR105W/BP3T4	
20	Electronic control box termin	1.0	17222300000790		
20.1	Terminal block	1.0	17400401000135	IXZ-PD6Z-C	
20.1	Terminal block	1.0	17400401000084	IXZ-PD9Z-C	
20.2	Terminal board assembly	1.0	12222300000033		
20.3	Terminal board assembly	1.0	12222300000032		
21	4-way valve assembly	1.0	15422000019432		
21.1	4-way valve	1.0	15500216000361	STF-02BN1	
21.2	Gas valve	1.0	15500204000049	DYF-D-19-19N1	
21.3	Pressure switch	1.0	17400516000851		
21.4	Muffler	1.0	15122000027837	CAUS1-KFR105W/BP3	
22	High pressure valve assembly	1.0	15422300000364		
22.1	High pressure valve	4.0	155002080000028	GYF-A28N	
22.2	Electronic expansion valve su	4.0	15500213000046	DPF(TS) 1.65C-63(L	
23	High pressure valve assembly	1.0	15422000016293		
23.1	High pressure valve	1.0	155002080000047		
24	Copper nut	4.0	15500406000016	TLM-A01	
24	Copper nut	1.0	15500406000012	TLM-C03	
24	Copper nut	3.0	15500406000010	TLM-B02	
26	compressor	1.0	11103020000719	KTF310D43UMT	
27	Reactor	1.0	174003060000058	R25027 (AL) (1)	
29	Discharge temperature sensor	1.0	112010070030124	CGQ-WD/PQ3950-11000-XHBCP2R6-G950	
30	Electric heater of chassis	1.0	17402020000466	DJRG-150W-350-2	
31	Crankcase electric heater	1.0	17402001000601	DJRD-390A-800-25W-2	
33	Gas valve	1.0	15422300000365		
33.1	Gas valve	1.0	155002040000058	DYF-R29N	
33.1	Gas valve	3.0	155002040000021	DYF-A28N	
34	compressor suction pipe assem	1.0	15122300001024		
34.1	Pressure switch	1.0	17400516000848	YK-0.14/0.3-500	
39	accumulator cylinder	1.0	155005080000315	ZYT-12	
43	Transfer connector	1.0	15500303002547	ZHITZ1-6.35-9.52	
43	Transfer connector	1.0	15500303002546	ZHITZ1-12.7-16	
43	Transfer connector	3.0	15500303002545	ZHITZ1-9.52-12.7	
43	Transfer connector	1.0	15500303002544	ZHITZ1-12.7-9.52	
44	Pipe temperature sensor subas	1.0	112010070000007	CGQ-WD/GW4100-1.1400-XHD8-P1300-04	
99	Compressor wire assembly	1.0	17401203000939		