

## PRN530DX PARTS LIST

NO.	Part English Name
1	EVAPORATOR FAN BLADE
2	EVAPORATOR FAN MOTOR
3	BOTTOM RIGHT HINGE
4	BOTTOM LEFT HINGE
5	K STRIP(8 HOLES)
6	K CLIP
7	COMPRESSOR
8	NUT OF INTERIOR CABINET DRAIN CONNECTOR
9	HINGE AXIS
10	MIDDLE SHELF
11	INNER DRAIN PAN
12	CONDENSOR
13	CONDENSER FAN MOTOR
14	CONDENSER FAN BLADE
15	CONDENSER FAN MOTOR COVER
16	CASTER WITH BRAKE(WITH BASEPLATE)
17	CABINET
18	UPPER RIGHT HINGE
19	RIGHT SHELF
20	CASTER WITHOUT BRAKE(WITH BASEPLATE)
21	BACK GIRLL
22	PIPE COVER
23	AXIS COVER
24	EXTERIOR DRAIN PAN
25	DRAIN PAN HOLDER
26	INSTALLATION PLATE
27	LEFT TRACK FOR INSTALLATION PLATE
28	RIGHT TRACK FOR INSTALLATION PLATE
29	INSTALLATION PLATE LIMITED BLOCK
30	TRANSFORMER OF TEMP DISPLAY
31	UPPER LEFT HINGE
32	LEFT SHELF
33	LEFT GLASS DOOR
34	INTERIOR CABINET DRAIN CONNECTOR
35	LAMP SWITCH(GREEN)
36	BRACKET OF MACHINE ROOM
37	RIGHT LINKER OF CASTER MOUNTING PLATE
38	LEFT LINKER OF CASTER MOUNTING PLATE
39	POWER SWITCH(RED)
40	DIGITAL TMEPERATURE CONTROLLER
41	TEMPERATURE DISPLAY
42	LIGHT SOCKET
43	INTERIOR LIGHT INSTALLATION PLATE
44	INTERIOR LIGHT
45	LIGHT BOX FRAME
46	LIGHT BOX PANEL
47	GLASS DOOR HANDLE
48	BOTTOM COVER OF ELECTRICAL BOX
49	ELECTRICAL BOX
50	FRONT GRILL
51	CASTER MOUNTING PLATE
52	EVAPORATOR
53	DRAIN TUBE (Φ20mm)
54	DRY FILTER
55	DRY FILTER FIXER
56	BALLAST OF LIGHT
57	GLASS DOOR GASKET
58	DOOR SWITCH
59	EVAPORATOR FAN COVER
60	EVAPORATOR FAN MOTOR BRACKET
61	LEFT BRACKET FOR EVAPORATOR
62	RIGHT BRACKET FOR EVAPORATOR
63	EVAPORATOR FAN MOTOR COVER
64	TOP LIGHT
65	TOP LIGHT INSTALLATION PLATE
66	LIGHT SOCKET
67	BALLAST OF LIGHT

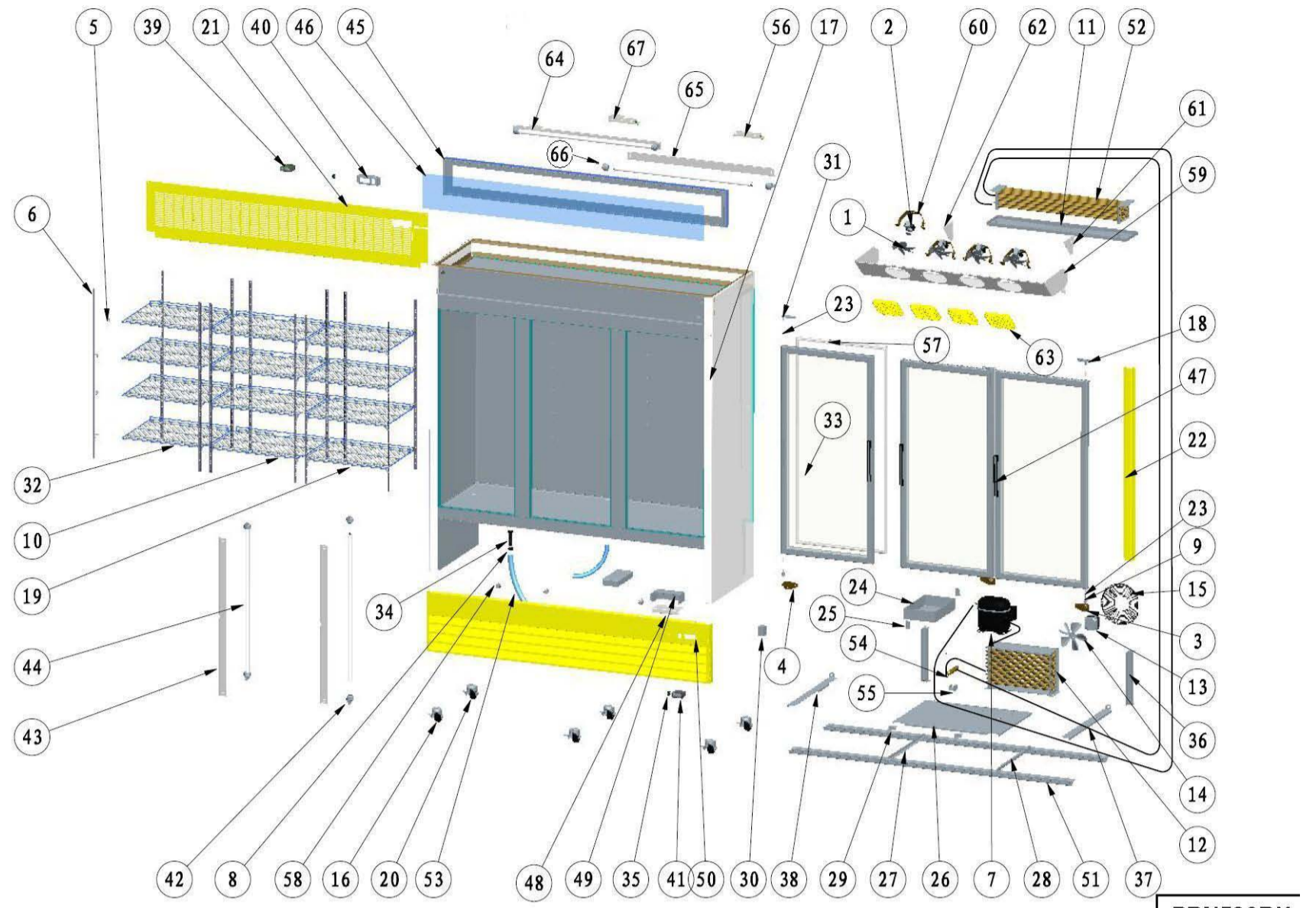

PRN530DX